

# BT30 New Drill Mill Chucks

## Wide Range of Use

Various cutting tools including drill bits, tapping drills, reamers, and end mills can be chucked.

## High Gripping Force

That is an advantage of double taper collets.

## Applicable to high-pressure coolant

Coolant of high pressure up to 7.0MPa is usable.

## High Balancing

Grinding of the external surface of the holder secures a high balancing.

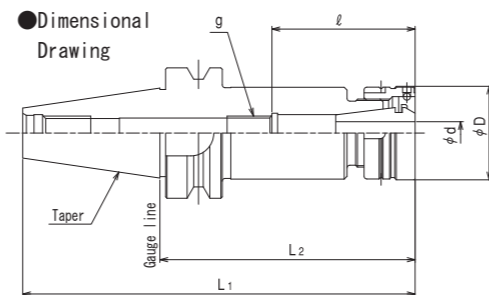
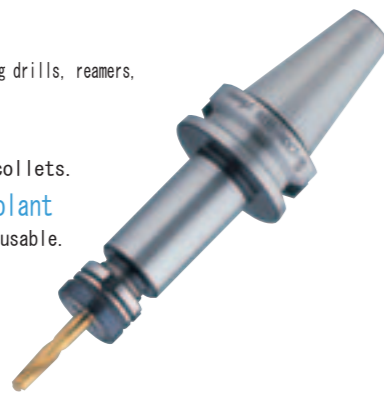

Unit: mm													
Model	Gripping Capacity d	Nut Outside Diameter D	Total Length L1	Length from the Gauge Line L2	Length Adjustment Screw g		Taper	Applicable Collet (option)	Applicable Lock Nut	Applicable Spanner (option)	Length Adjustment Screw (option)	Coolant Seal Screw (option)	Weight (kg)
BT30 -NDC7S-60	0.5~7.0	22	108.4	60	M8×0.75	55	BT30 7/24	YCC7	NDN7S	FS22	APM7-2	CSH7	0.5
-NDC7S-90			138.4	90									0.6
-NDC7S-120			168.4	120									0.7
BT30 -NDC7-60		25	108.4	60					0.5				
-NDC7-90			138.4	90					0.6				
-NDC7-120			168.4	120					0.7				
BT30 -NDC10-60	0.5~10.0	33	108.4	60	M12×1.5	50		YCC10	NDN10	FS33	APM10-2	CSH10	0.5
-NDC10-90			138.4	90									0.7
-NDC10-120			168.4	120									0.9
BT30 -NDC13-60	0.5~13.0	36	108.4	60	M15×1.5	62		YCC13	NDN13	FS36	APM13-2	CSH13	0.5
-NDC13-90			138.4	90									0.7
-NDC13-120			168.4	120									0.9
BT30 -NDC16-75	2.5~16.0	42	123.4	75	M18×1.5	68	YCC16	NDN16	FS42	APM16-2	CSH16	0.7	
-NDC16-105			153.4	105								0.9	
-NDC16-120			168.4	120								1.1	
BT30 -NDC20-75	3.5~20.0	52	123.4	75	M15×1.5	60	YCC20	NDN20	FS52	APM13-1	—	—	0.7
※ -NDC20-105			153.4	105									1.0
-NDC20-120			168.4	120									1.2
※ BT30 -NDC25-90	5.0~25.0	62	138.4	90	M15×1.5	80	YCC25	NDN25	FS62	APM13-2	—	—	1.0
※ -NDC25-120			168.4	120									1.7

※Coolant seal screw cannot be used. ◆Dimensions of the Taper Shank are in accordance with MAS 4003-1982 BT Tapered Shank ◆Dimensions of Max. L are those when length adjustment bolt -APM type is used. ◆Collet, spanner, retention knob, coolant sealing back up screw, length adjustment bolt are not included in the above. They are separate accessories.

# BT30 Power Lock Milling Chucks

## High gripping torque

Gripping torque was increased by making the tightening collar thicker, and by strengthening tightening of the opening by modifying chuck ID with straight slit.

## Coolant can be used

Coolant can be used, regardless of tool with or without coolant-thru hole.

## High Rigidity · High Accuracy

High rigidity thanks to tightening collar end holding system (duplex holding) and it is manufactured with concentricity within 0.005mm

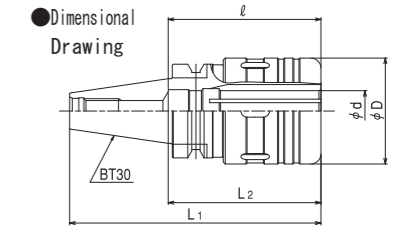

Unit: mm										
Model	Grip Diameter d	Nut Outside Diameter D	Total Length L1	Length from the Gauge Line L2	Maximum φ	Taper	Applicable Collet (option)	Applicable Spanner (option)	Weight (kg)	
BT30 -PMC20-75	20	52	123.4	75	75	BT30 7/24	SCR20 SCA20 SCC20	FS55	0.96	
-PMC20-120			168.4	120	75				1.55	

※Please use a tool of which shank diameter tolerance h7. ※Dimensions of tapered shank are in accordance with MAS4003-1982 BT Tapered shank. ※Straight collet and Spanner are not included in the above. They are separate accessories.

## Straight Collets

### For normal use

Collet for chucking straight shank of small diameter

### For adjustment use

Collet with adjustment bolt which enable to set tool easily.

### For coolant-thru tool

Suitable when using tool with coolant-thru hole.



Model	Bore Size	Model	Bore Size	Model	Bore Size
SCR20-	6,8,10,12,16	SCA20-	6,8,10,12,16	SCC20-	6,8,10,12,16

※ Please use a tool of which shank diameter tolerance h7. ※ Tool must be inserted into collet deep enough to secure retaining length. ※ Straight collet of size 6,8,10,12 are made to order.

## Hook Spanners



Model: FS55

## Drill Mill Collets



Unit: mm					
Model	Bore Size	Collet Gripping Capacity d	Outside Diameter	Length	Applicable Main Body
YCC7-	1, 1.5, 2, 2.5, 3, 3.5, 4, 5, 6, 7	0.5~7.0	13	20	NDC7, 7S
YCC10-	1, 1.5, 2, 2.5, 3, 3.5, 4, 5, 6, 7, 8, 9, 10	0.5~10.0	18	28	NDC10
YCC13-	1, 1.5, 2, 2.5, 3, 3.5, 4, 5, 6, 7, 8, 9, 10, 11, 12, 13	0.5~13.0	22	32	NDC13
YCC16-	3, 3.5, 4, 5, 6, 7, 8, 9, 10, 11, 12, 13, 14, 15, 16	2.5~15.0	26	35	NDC16
YCC20-	4, 5, 6, 7, 8, 9, 10, 11, 12, 13, 14, 15, 16, 17, 18, 19, 20	3.5~20.0	34	45	NDC20
YCC25-	6, 7, 8, 9, 10, 11, 12, 13, 14, 15, 16, 17, 18, 19, 20, 21, 22, 23, 24, 25	5.0~25.0	42	56	NDC25

※ In addition to the standard collets, AA-class collets of higher runout accuracy are also available. When to order AA-class, it must be specified accordingly. ※ 0.5~1.0mm of chucking capacity. ※ When chucking an end-mill, please use the collet of which maximum capacity is equal to the dia. of the end-mill shank. ※ Special sizes of collets are also available.

## BT30 Pencil Mill Chucks

### Slim head

The slim head of the chuck will prevent unnecessary collision with workpiece and will improve the operation efficiency.

### Method to secure a stable high precision

The pencil mill chuck draws collet straight without screwing the draw-bar without the collet being twisted, which will keep the accuracy to be stable.

### Runout within 5μ (Special specifications)

Super precision type guarantees the runout accuracy to be within 5μ at 25mm distance from the holder's head.

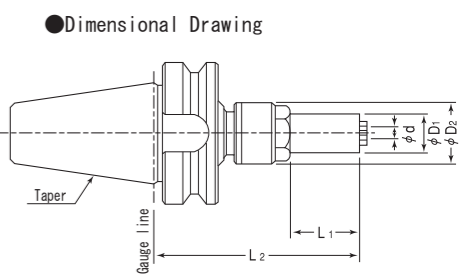

Unit: mm										
Model	Collet Gripping Capacity d	Taper	D1	D2	L1	L2	Applicable Collet (option)	Applicable Spanner (option)	Weight (kg)	
BT30 -PCH6-90	3~6	BT30	17	27	31	90	YPC6	KS 6	0.56	
-PCH10-100	3~10		23	34	45	100			YPC10	KS10

※Collet, retention knob and spanner are not included in the above. They are separate accessories. ※Special sizes of pencil mill chucks are also available by special order.

## Pencil Mill Chucks



Unit: mm						
Model	Bore Size	Outside Diameter	Length	Inside Screw	Applicable Main Body	
YPC 6-	3,4,6	13	39	M8 ×1.25	PCH6	
YPC10-	3,4,6,8,10	18	54	M10×1.25	PCH10	

## Single Head Spanners



Model	Applicable Main Body
KS 6	PCH6
KS10	PCH10

## NDN Lock Nuts

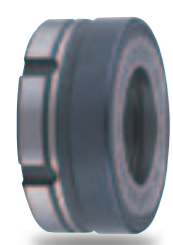

Model	M	Applicable Main Body	Applicable Collet
NDN7S	M16×1.0	NDC7S	YCC7
NDN7	M18×1.0	NDC7	
NDN10	M24×1.0	NDC10	YCC10
NDN13	M28×1.0	NDC13	YCC13
NDN16	M33×1.5	NDC16	YCC16
NDN20	M42×1.5	NDC20	YCC20
NDN25	M50×1.5	NDC25	YCC25

## Hook Spanners



Model	Applicable Main Body	Applicable Lock Nut
FS22	NDC7S	NDN7S
FS26	NDC7	NDN7
FS33	NDC10	NDN10
FS36	NDC13	NDN13
FS42	NDC16	NDN16
FS52	NDC20	NDN20
FS62	NDC25	NDN25

※Hook spanners are separate accessories.

## Spanners with Torque Limiters



Model	Recommended Torque (Nm)	Applicable Main Body	Applicable Lock Nut
FS22T	13	NDC7S	NDN7S
FS26T	13	NDC7	NDN7
FS33T	20	NDC10	NDN10
FS36T	30	NDC13	NDN13

※Torque-fixed type with recommendable torque. ※Hook spanners are separate accessories.

## BT30 Floating Tap Holders

■The built-in radial float mechanism compensates the centering deviation, if any, between the spindle and the workpiece, which will eventually secure the precise tapping work.

Tap Holders



●Dimensional Drawing

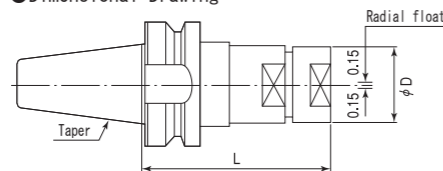

Unit: mm

Model	Tapping Capacity	Taper	L	D	Applicable Collet (option)
BT30 -FTH10-75	M3~M10	BT30	75	29	TSC10
-FTH10-90			90		

※ Collet, spanner and retention knob are not included in the above. They are separate accessories.

Tap Collets

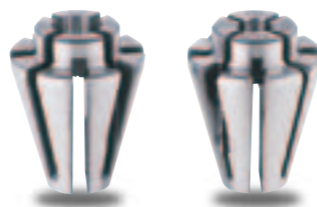

Model	Applicable Main Body
TSC10-M3	FTH10
TSC10-M4	
TSC10-M5	
TSC10-M6	
TSC10-M8	
TSC10-M10	

## BT30 Face Mill Arbors



●Dimensional Drawing

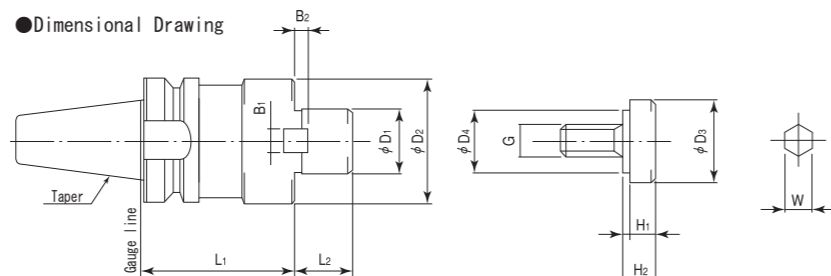

Unit: mm

Model	Taper	D <sub>1</sub>	L <sub>1</sub>	D <sub>2</sub>	L <sub>2</sub>	B <sub>1</sub>	B <sub>2</sub>	G	D <sub>3</sub>	D <sub>4</sub>	H <sub>1</sub>	H <sub>2</sub>	W	Weight (kg)
BT30 -FMA22-40	BT30	22.0	40	45	18	φ10	5	M10	—	—	8	—	6	0.70
-FMA22-60			60											0.90
BT30 -FMA22.225-40			40											0.70
-FMA22.225-60		60	0.90											
-FMA22.225-90		90	1.30											
BT30 -FMA25.4-60		25.4	60	1.00										
-FMA25.4-90	90		1.50											

※ Special sizes are also available.  
※ Retention knob is a separate accessory.

## BT30 Jacobs Taper Arbors

■These arbors are manufactured by using prototype of the taper gage in high quality control to achieve taper contact better than 85%, thus, enabling to assure the superior endurance and the high accuracy



●Dimensional Drawing

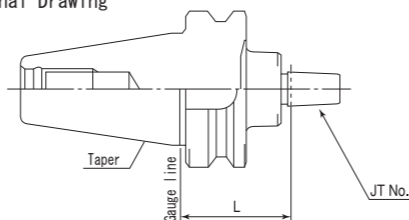

Unit: mm

Model	Jacobs Taper	Taper	L	Weight (kg)
BT30-JTA1-30	JTNo.1	BT30	30	0.40
BT30-JTA2S-30	JTNo.2S	BT30	30	0.50
BT30-JTA6-30	JTNo.6	BT30	30	0.50

## CNC Keyless Drill Chucks with BT30 Shank

■Integration of shank and chuck made its compact size and safety.  
■Re-tightening with hook spanner prevents loosening at an emergency stopping.  
■Run-out accuracy: smaller than 0.05mm



●Dimensional Drawing

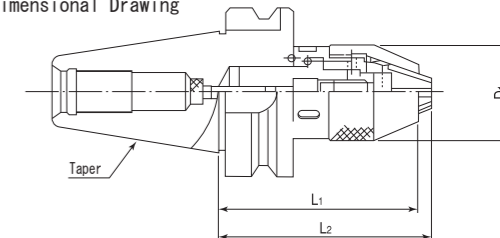

Unit: mm

Model	Gripping Capacity	D <sub>1</sub>	L <sub>1</sub>	L <sub>2</sub>	Taper	Applicable Spanner	Weight (kg)
BT30-LC6.5F-70	0.5~6.5	34	70	76	BT30	FS6.5LC	0.60
BT30-LC13F-90	0.5~13	50	90	102		FS13LC	1.15

## Super Keyless Drill Chucks with BT30 Shank

■The sleeve-lock mechanism working in reverse rotation.  
■M16 tapping available.  
■Run-out accuracy: smaller than 0.05mm



●Dimensional Drawing

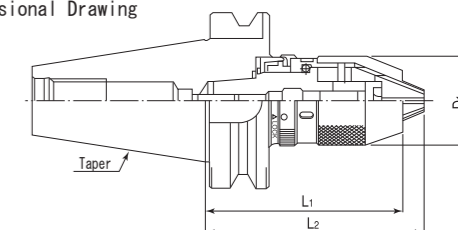

Unit: mm

Model	Gripping Capacity	D <sub>1</sub>	L <sub>1</sub>	L <sub>2</sub>	Taper	Applicable Spanner	Weight (kg)
BT30-SLC13-110	0.5~13	51	110	122.5	BT30	FS13LC	1.38

## Keyless Drill Chucks

■World highest precision, manufactured with integration of our production technology and quality control.  
■Run-out accuracy: smaller than 0.05mm  
<Gold> Less than 0.03mm  
<Silver> Less than 0.05mm



Unit: mm

Ultraprecise Type	Precise Type	Gripping Capacity	Taper	Outside Diameter	Length (closed claws)	Length (open claws)	Weight (kg)
LC3-J0 gold	LC3-J0 silver	0.3~3	JTNo.0	24	48	44	0.10
LC3-J1 gold	LC3-J1 silver	0.3~3	JTNo.1	24	48	44	0.10
LC6.5 gold	LC6.5 silver	0.5~6.5	JTNo.1	34	68	62	0.30
LC8 gold	LC8 silver	0.5~8	JTNo.2S	38	76	68.5	0.40
LC10 gold	LC10 silver	0.5~10	JTNo.2S	43	91	80	0.63
LC13 gold	LC13 silver	0.5~13	JTNo.6	50	103	91	0.94
LC16 gold	LC16 silver	3~16	JTNo.6	56	109	96	1.25

## Super Keyless Dream Chucks

■The sleeve-lock mechanism working in reverse rotation.  
■M16 tapping available.  
■Run-out accuracy: smaller than 0.05mm



●Dimensional Drawing

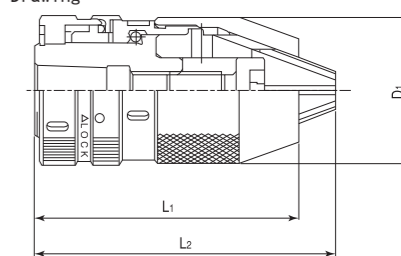

Unit: mm

Model	Gripping Capacity	D <sub>1</sub>	L <sub>1</sub>	L <sub>2</sub>	Taper	Applicable Spanner	Weight (kg)
SLC13-J6	0.5~13	51	90.5	103	JT6	FS13LC	1.04
SLC13-J33	0.5~13	51	90.5	103	JT33	FS13LC	1.05